



WINDSOR PLACE





# THE ROYAL

- 3 BEDROOMS
- 2 BATHS
- FORMAL DINING ROOM
- SEPARATE FAMILY ROOM

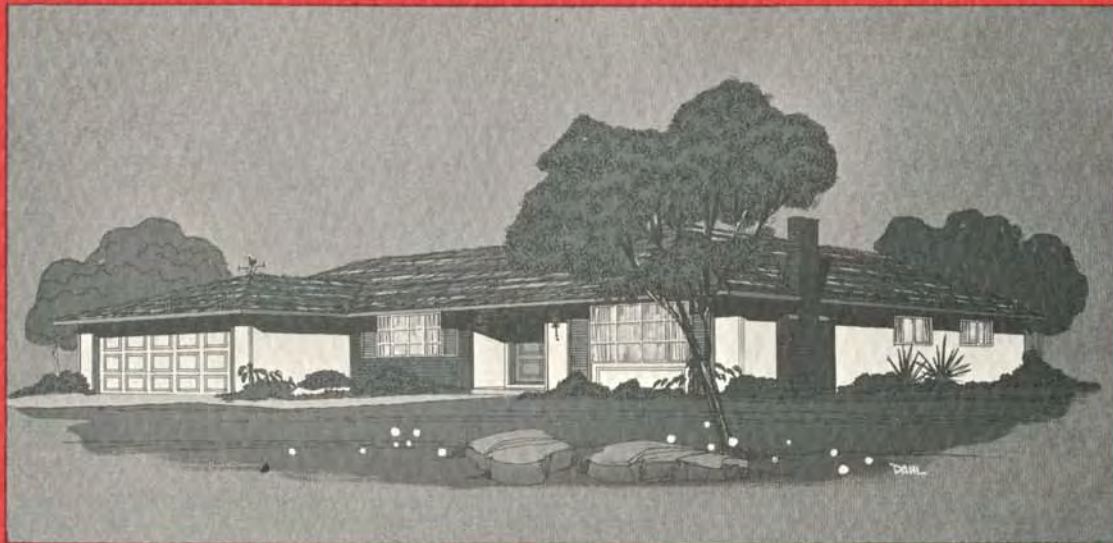
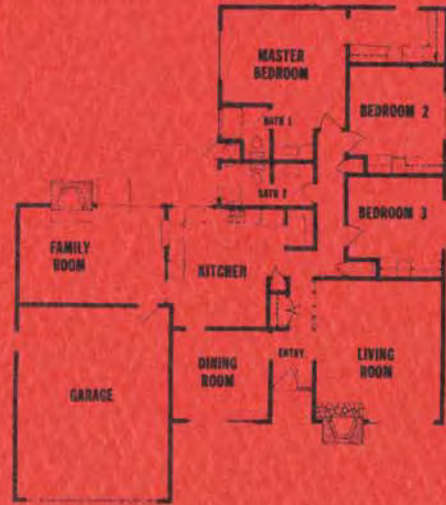

# THE LANCER

- 4 BEDROOMS
- 2 1/2 BATHS
- FORMAL DINING ROOM
- SEPARATE FAMILY ROOM

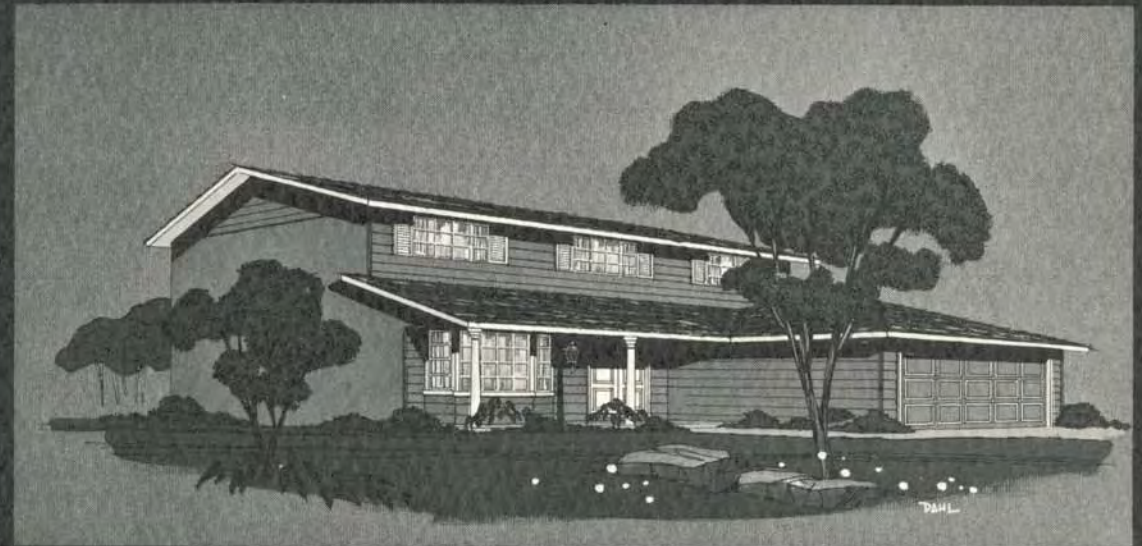





## THE WINDSOR

- 4 BEDROOMS
- 2 1/2 BATHS
- FORMAL DINING ROOM
- SEPARATE FAMILY ROOM



## WINDSOR PLACE

YOU WILL FIND THESE LUXURIOUS FEATURES INCLUDED IN YOUR WINDSOR PLACE HOME AT NO EXTRA COST!

8,000 SQ. FT. LOTS WITH A SELECT NUMBER OF CUSTOM ESTATE LOTS TO 11,728 SQ. FT. • ALL WOOD EXTERIORS • HEAVY SHAKE ROOFS • OLYMPIC STAIN EXTERIORS • CERAMIC TILE ENTRY • FULL PERIMETER FACIA GUTTERS • FORMICA FACED CABINETS • CERAMIC COUNTER TOPS • BUILT-IN NU TONE MIXER BLENDER • WESTINGHOUSE DISHWASHER AND GARBAGE DISPOSAL • DOUBLE OVEN WITH MAGIC MIRROR DOORS • THERMADOR RANGE—FEATURING "GRIDDLE IN GRILL" • LUMINOUS RECESSED LIGHTING IN KITCHENS • FORCED AIR PERIMETER HEAT • KOMAR MARBLE VANITY TOPS • FIREPLACE • FRAMED MIRROR IN BATHS • DRESSING AREA IN MASTER BEDROOM • CHOICE OF ACOUSTICAL CEILINGS OR PAINTED CEILINGS • 220 WIRING FOR DRYERS • ENTRANCE TO BATH FROM BACK YARD • WEATHER PROOF ELECTRICAL OUTLET IN PATIO AREA • SOLID BOARD REDWOOD FENCE WITH POSTS IN CONCRETE • FRONT LAWNS • HARDWOOD FLOORS • CEDAR FLOORS • CUSTOM LIGHTING FIXTURES • AND MANY OTHER QUALITY FEATURES



LOCKHEED

MOUNTAIN VIEW

BAYSHORE FWY.

EL CAMINO REAL

SUNNYVALE

GRANT ROAD

MARY AVE.

POME AVE.



TRENTON

LOS ALTOS

FREMONT AVE.

HOLLENBECK

HIGHWAY 9

HOMESTEAD ROAD

## THE WINDSOR DEVELOPMENT COMPANY PROUDLY ANNOUNCES...

A NEW METHOD OF BUILDING CUSTOM QUALITY HOMES. IT IS OUR DESIRE TO BRING TO PROSPECTIVE BUYERS A METHOD OF CUSTOMIZING THEIR HOMES AT MINIMUM COST. THIS EXCLUSIVE SUBDIVISION IS ARCHITECTURALLY PLANNED . . . AND COLOR COORDINATED FOR INDIVIDUAL TASTES. OUR METHOD OF QUALITY CONTROL BUILDING HAS PROVEN SUCCESSFUL TO BOTH BUILDER AND HOME OWNER.

WE THANK YOU FOR YOUR CONSIDERATION IN ADMIRING OUR HOMES.

**The WINDSOR DEVELOPMENT Co.**

JULIUS M. BAHL  
PETER R. HODGKINSON  
DONALD J. BAHL